

TESTING

SYSTECO's product has been tested and approved at the Hurricane Test Laboratory in Miami-Dade County, Florida, United States. (HTL Report G418-0202-06), to sustain hurricane force winds up to 150 mph. Part of this process involved testing by NTA (NTA Testing CSI 05-05400) which demonstrated that the building shells can also withstand

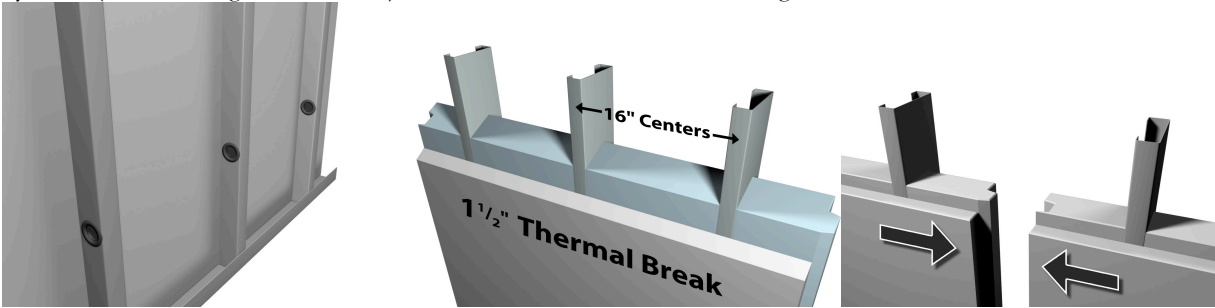

SYSTECO's product's integrity has been approved by the US Army Corps of Engineers. The Army Corps of Engineers, based in Washington, D.C. tested the steel + foam construction technique for its military housing. Within weeks after Hurricane Katrina, the US Army Corps of Engineers utilized the product to design and build housing in Mississippi.

SYSTECO's manufacturing plant design is highly flexible in that it can be tailored towards heavy automation or a combination of semi-automation and a greater use of labor. However, **SYSTECO's** management team desires to use more labor in its production plant processes in order to employ more people, providing jobs to areas where **SYSTECO** has established a plant. As production volumes increase, the Company has the flexibility to ramp up automation as it chooses. **SYSTECO's** plant design is easily **transportable** as well, allowing for a high degree of flexibility to locate near end-user markets, thus reducing transportation costs.